

Asbestos Bulk Sampling Report

4701 Silver Hill Road

Suitland, MD 20746

KEM Project No. 23167

November 8, 2018



Prepared For Prince George's County Government

KEM

Kynoch Environmental Management

November 8, 2018

Mr. Donny James, Chief Real Estate Office
Prince George's County Government
1300 Mercantile Lane, Suite 108
Largo, MD 20774

Subject: Asbestos Bulk Sampling
4701 Silver Hill Road,
Suitland, MD 20746
KEM Project No. 23167

Dear Mr. Donny James:

Kynoch Environmental Management (KEM) is pleased to present the following Asbestos Bulk Sampling Report for the project completed at 4701 Silver Hill Road, Suitland, Maryland 20746.

We appreciate the opportunity to provide this service to Prince George's County Government. Please feel free to contact us at (301) 961-1653 in case you have any questions or comments.

Sincerely,

A handwritten signature in black ink, appearing to read 'Carlos Elizondo', written in a cursive style.

Carlos Elizondo
Executive Vice President

Reviewed By:

A handwritten signature in black ink, appearing to read 'Jeffrey Suhr', written in a cursive style.

Jeffrey Suhr
Senior Vice President

TABLE OF CONTENTS

<u>Section</u>	<u>Page</u>
1.0 Executive Summary	4
2.0 Background	5
3.0 Regulations & References	5
4.0 Means & Methods	5
5.0 Asbestos Inspection	6
6.0 Conclusions and Recommendations	7
7.0 Limitations	8

Appendix A – Homogeneous Material List
Appendix B – PLM Analytical Bulk Sample Results
Appendix C – Floor Plan with Sample Locations

1.0 Executive Summary

Kynoch Environmental Management, Inc. (KEM) was retained by Prince George's County Government to perform a limited asbestos survey of the building located at 4701 Silver Hill Road, Suitland, Maryland 20746.

KEM, represented by Teymur Schwartz, Maryland licensed Asbestos Inspector (#18006801), visited the site on 9/6/18 to inspect and sample for suspect asbestos-containing materials (ACMs) within the building's First Floor and Basement that may be impacted by the renovation/repair at the subject property.

Sampling and analysis determined that the following materials contain greater than one percent (>1%) asbestos and are considered ACMs:

- Wall mastic material; Color: Black; Location: 1st Floor
- Drywall joint compound material; Color: White; Location: 1st Floor and Basement/Basement Stairwell

KEM also inspected the building for mold. Visible mold is present on drywall systems throughout the building on both floors. In a separate mold inspection report, KEM recommended removal of all drywall in the building. Because the drywall joint compound is an ACM, asbestos regulations take precedence and the removal of mold impacted drywall is considered an asbestos abatement project.

The ACM wall mastic may be left in-place and does not require abatement.

OSHA 29 CFR 1910.1001 and 29 CFR 1926.1101, the General Industry and Construction Industry Standards for asbestos respectively, require that the building owner and/or general contractor inform contractors, trades, and their employees of the presence and location of ACM and presumed ACM (PACM) prior to the onset of work. KEM recommends that this report and all other available data and drawings relating to asbestos be provided to ALL contractors and trades working on the site to protect themselves and their employees from asbestos exposure.

2.0 Background

KEM was retained by Prince George's County Government to perform a limited asbestos survey for Prince George's County Government for the property located at 4701 Silver Hill Road in Suitland, Maryland. The subject property is comprised of a First Floor and a Basement level. KEM's sampling was strictly limited to the First Floor and Basement area.

3.0 Regulations & References

The asbestos content of materials is expressed as a percent. An asbestos-containing material (ACM) is a material containing greater than one percent (1%) asbestos. Friable asbestos materials are materials containing greater than one percent (1%) asbestos that, when dry, can be crumbled, pulverized, or reduced to powder by hand pressure. Non-friable materials can become friable and regulated under certain conditions (e.g. sanding, sawing, cutting, etc.). Friable building materials containing greater than one percent (1%) asbestos are regulated under the United States Environmental Protection Agency's (EPA) National Emission Standards for Hazardous Air Pollutants (NESHAP). A list of applicable federal regulations include:

- ✓ *National Emission Standard For Hazardous Air Pollutants (NESHAP, 40 CFR Part 61)* – Establishes the United States Environmental Protection Agency (USEPA) regulatory notification requirements and emission control practices when renovating or demolishing any institutional, commercial, public, industrial, or residential building (excluding residential buildings with four or fewer individual dwelling units). Under NESHAP, regulated asbestos-containing materials (RACM) include:
 - a) Friable ACM
 - b) Category I nonfriable ACM that has become friable
 - c) Category I nonfriable ACM that will be or has been subjected to sanding, grinding, cutting, or abrading
 - d) Category II nonfriable ACM that has a high probability of becoming or has become crumbled, pulverized, or reduced to powder by the forces expected to act on the material in the course of demolition or renovation operations regulated by NESHAP (40 CFR Part 61 Subpart M).
- ✓ *Asbestos Hazardous Emergency Response Act (AHERA, 40 CFR Part 763)* – Establishes the general requirements for the identification and characterization of ACM when conducting an asbestos survey. Applies primarily to schools, but provides a standardized survey procedure that is readily applicable to non-school projects. The AHERA defines a homogeneous area as an area of surfacing material, thermal system insulation material, or miscellaneous material that is uniform in color and texture.
- ✓ *Asbestos School Hazard Abatement Reauthorization Act (ASHARA)* – extended the AHERA regulations, including asbestos training/accreditation requirements, to public and commercial buildings (in addition to schools).
- ✓ *Occupational Safety and Health Administration (OSHA) Asbestos in Construction Regulations (29 CFR 1926.1101)* – Establishes the permissible occupational exposure limits and emission control practices required of those workers disturbing ACM during renovation and demolition activities. Under the OSHA Asbestos in Construction Regulations, presumed asbestos containing material (PACM) is defined as thermal system insulation and surfacing material found in buildings constructed no later than 1980.

4.0 Means & Methods

KEM personnel performed a limited visual survey of the building(s) to identify homogenous areas of suspect ACM in accessible areas. After identifying suspect ACMs and homogeneous areas, KEM personnel physically touched each suspect ACM to evaluate friability. KEM personnel then collected bulk samples of the suspect ACMs in general accordance with AHERA guidelines. The bulk samples were then placed in polyethylene bags, assigned unique sample numbers, and then transported (following Chain of Custody protocol) to Scientific Analytical Institute (SAI), in Greensboro, North Carolina, for analysis. SAI is an independent laboratory accredited through the National Voluntary Laboratory Accreditation Program

(NVLAP), and an American Industrial Hygiene Association (AIHA) accredited laboratory. SAI analyzed the collected samples by Polarized Light Microscopy (PLM) with dispersion staining techniques according to the methods specified in 40 CFR Part 763 Subpart F, Appendix A (method EPA/600/R-93/116 - visual estimate).

5.0 Asbestos Inspection

On 9/6/18, Kynoch Environmental Management (KEM), represented by Industrial Hygienist Teymur Schwartz, Maryland licensed Asbestos Inspector (#18006801), performed a visual inspection and collected bulk samples.

KEM collected twenty-eight (28) bulk samples (including layers) consisting of ten (10) different homogeneous areas. A homogeneous area is defined under AHERA as any suspect material of the same color and texture. The collected samples were analyzed via polarized light microscopy (PLM). A complete table of sampled materials and a copy of the results, provided by SAI, are included in Appendix A and B, respectively.

Analysis determined that the following materials contain greater than one percent (>1%) asbestos and are considered ACMs:

- Wall mastic material; Color: Black; Location: 1st Floor (see photographs below)
- Drywall joint compound material; Color: White; Location: 1st Floor and Basement/Basement Stairwell



Figure 5.1. Asbestos-containing black wall mastic, close-up.



Figure 5.2. Asbestos-containing black wall mastic from a distance.

6.0 Conclusions and Recommendations

Analysis determined that the following materials contain greater than one percent (>1%) asbestos and are considered ACMs:

- Wall mastic material; Color: Black; Location: 1st Floor
- Drywall joint compound material; Color: White; Location: 1st Floor and Basement/Basement Stairwell

KEM also inspected the building for mold. Visible mold is present on drywall systems throughout the building on both floors. In a separate mold inspection report, KEM recommended removal of all drywall in the building. Because the drywall joint compound is an ACM, asbestos regulations take precedence and the removal of mold impacted drywall is considered an asbestos abatement project. KEM recommends that a asbestos abatement to remove all drywall systems in the building.

The ACM wall mastic may be left in-place and does not require abatement. However, the wall mastic is required to be abated prior to any renovation activities that may render the wall mastic friable.

OSHA 29 CFR 1910.1001 and 29 CFR 1926.1101, the General Industry and Construction Industry Standards for asbestos respectively, require that the building owner and/or general contractor inform contractors, trades, and their employees of the presence and location of ACM and presumed ACM (PACM) prior to the onset of work. KEM recommends that this report and all other available data and drawings relating to asbestos be provided to ALL contractors and trades working on the site to protect themselves and their employees from asbestos exposure.

7.0 Limitations

Every reasonable attempt was made to safely locate hazardous building materials. However, areas that were inaccessible at the time of the survey can only be addressed through extrapolation of conditions in the accessible building space, information obtained from persons knowledgeable of the areas inspected, and if available, review of building plans, specifications, or other building documents provided to KEM.

Changes in the condition of the site may occur with time due to either natural processes or human activities. The findings presented in this report are based on site conditions existing at the time of the inspection. KEM cannot be responsible for any errors or omissions in this inspection resulting from incomplete or inaccurate disclosures.

Other concealed hazardous building materials (asbestos, lead, etc.) may be present; however, if the materials were not accessible, readily apparent, or covered by the scope of this project, identification and testing may not have been performed. Future construction activities may expose additional suspect building materials.

Appendix A

Homogeneous Material List



Homogeneous Materials Table

KEM Project Number: 23167

KEM Project Name: 4701 Silver Hill Road, Suitland, Maryland

Material Description	Observed Material Location(s)	Sample Number(s)	Friable (Yes/No)	Condition	% Asbestos (Positive / Negative)
Black wall mastic	First Floor	9-6-18-WM-1, 9-6-18-WM-2	No	Good	3% Chrysotile Positive
White Drywall joint compound	First Floor, Basement Stairs	9-6-18-JC-4, 9-6-18-JC-5	No	Good	4% Chrysotile Positive
Beige, white ceiling tile	First Floor	9-6-18-CT-6, 9-6-18-CT-7	n/a	Good	NAD
Tan cove base mastic	First Floor	9-6-18-CBM-8, 9-6-18-CBM-9	n/a	Good	NAD
Blue Floor tile 12x12	First Floor	9-6-18-FT-10 - A, 9-6-18-FT-11 - A	n/a	Good	NAD
Blue Floor tile 12x12 mastic	First Floor	9-6-18-FT-10 - B, 9-6-18-FT-11 - B	n/a	Good	NAD
Floor tile white w/blue specks	First Floor	9-6-18-FT-12- A, 9-6-18-FT-13- A	n/a	Good	NAD
Floor tile white w/blue specks mastic	First Floor	9-6-18-FT-12- B, 9-6-18-FT-13- B	n/a	Good	NAD
Tan Floor tile 12x24	First Floor	9-6-18-FT-14- A, 9-6-18-FT-15- A	n/a	Good	NAD
Tan Floor tile 12x24 mastic	First Floor	9-6-18-FT-14- B, 9-6-18-FT-15- B	n/a	Good	NAD



Homogeneous Materials Table

KEM Project Number: 23167
KEM Project Name: 4701 Silver Hill Road, Suitland, Maryland

Material Description	Observed Material Location(s)	Sample Number(s)	Friable (Yes/No)	Condition	% Asbestos (Positive / Negative)
Tan wallboard mastic	First Floor	9-6-18-WBM-16, 9-6-18-WBM-17	n/a	Good	NAD
Drywall	First Floor	9-6-18-DW-18, 9-6-18-DW-19	n/a	Good	NAD
Orange floor tile	First Floor	9-6-18-FT-20-A, 9-6-18-FT-21-A	n/a	Good	NAD
Orange floor tile mastic	First Floor	9-6-18-FT-20-B, 9-6-18-FT-21-B	n/a	Good	NAD
n/a = not applicable NAD = no asbestos detected					

Appendix B

PLM Analytical Bulk Sample Results



Bulk Asbestos Analysis

By Polarized Light Microscopy
 EPA Method: 600/R-93/116 and 40 CFR, Part 763, Subpart E,
 App.E



Customer: KEM
 6935 Wisconsin Ave Suite 306
 Chevy Chase, MD 20815

Attn: Carlos Elizondo

Lab Order ID: 51822875
Analysis ID: 51822875_PLM
Date Received: 9/7/2018
Date Reported: 9/11/2018

Project: 4701 Silver Hill Rd/23167

Sample ID	Description	Asbestos	Fibrous Components	Non-Fibrous Components	Attributes
Lab Sample ID	Lab Notes				Treatment
9-6-18-WM-1	Wall mastic (black)	3% Chrysotile		97% Other	Black Non Fibrous Homogeneous
51822875PLM_1					Crushed, Dissolved
9-6-18-WM-2	Wall mastic (black)	Not Analyzed			
51822875PLM_2					
9-6-18-JC-4	Drywall joint compound 1st floor	4% Chrysotile		96% Other	White Non Fibrous Homogeneous
51822875PLM_4					Crushed
9-6-18-JC-5	Drywall joint compound basement stairs	Not Analyzed			
51822875PLM_5					
9-6-18-CT-6	Ceiling tile 1st floor	None Detected	30% Cellulose 30% Fiber Glass	20% Perlite 20% Other	Beige, White Fibrous Homogeneous
51822875PLM_6					Teased, Ashed
9-6-18-CT-7	Ceiling tile 1st floor	None Detected	30% Cellulose 30% Fiber Glass	20% Perlite 20% Other	Beige, White Fibrous Homogeneous
51822875PLM_7					Teased, Ashed
9-6-18-CBM-8	Cove base mastic tan	None Detected		100% Other	Tan Non Fibrous Homogeneous
51822875PLM_8					Dissolved
9-6-18CBM-9	Cove base mastic tan	None Detected		100% Other	Tan Non Fibrous Homogeneous
51822875PLM_9					Dissolved

Disclaimer: Due to the nature of the EPA 600 method, asbestos may not be detected in samples containing low levels of asbestos. We strongly recommend that analysis of floor tiles, vermiculite, and/or heterogeneous soil samples be conducted by TEM for confirmation of "None Detected" by PLM. This report relates only to the samples tested and may not be reproduced, except in full, without the written approval of SAL. This report may not be used by the client to claim product endorsement by NVLAP or any other agency of the U.S. government. Analytical uncertainty available upon request. Scientific Analytical Institute participates in the NVLAP Proficiency Testing program. Unless otherwise noted blank sample correction was not performed. Estimated MDL is 0.1%.

William Howell (28)

Analyst

Approved Signatory



Bulk Asbestos Analysis

By Polarized Light Microscopy
 EPA Method: 600/R-93/116 and 40 CFR, Part 763, Subpart E,
 App.E



Customer: KEM
 6935 Wisconsin Ave Suite 306
 Chevy Chase, MD 20815

Attn: Carlos Elizondo

Lab Order ID: 51822875
Analysis ID: 51822875_PLM
Date Received: 9/7/2018
Date Reported: 9/11/2018

Project: 4701 Silver Hill Rd/23167

Sample ID	Description	Asbestos	Fibrous Components	Non-Fibrous Components	Attributes
Lab Sample ID	Lab Notes				Treatment
9-6-18-FT-10 - A	Floor tile blue 12x12 & mastic	None Detected		100% Other	Green, Blue Non Fibrous Homogeneous
51822875PLM_10	tile				Dissolved
9-6-18-FT-10 - B	Floor tile blue 12x12 & mastic	None Detected		100% Other	Yellow Non Fibrous Homogeneous
51822875PLM_22	mastic				Dissolved
9-6-18-FT-11 - A	Floor tile blue 12x12 & mastic	None Detected		100% Other	Green, Blue Non Fibrous Homogeneous
51822875PLM_11	tile				Dissolved
9-6-18-FT-11 - B	Floor tile blue 12x12 & mastic	None Detected		100% Other	Yellow Non Fibrous Homogeneous
51822875PLM_23	mastic				Dissolved
9-6-18-FT-12 - A	Floor tile white w/blue specks	None Detected		100% Other	Beige Non Fibrous Homogeneous
51822875PLM_12	tile				Dissolved
9-6-18-FT-12 - B	Floor tile white w/blue specks	None Detected		100% Other	Brown Non Fibrous Homogeneous
51822875PLM_24	mastic				Dissolved
9-6-18-FT-13 - A	Floor tile white w/blue specks	None Detected		100% Other	Beige Non Fibrous Homogeneous
51822875PLM_13	tile				Dissolved
9-6-18-FT-13 - B	Floor tile white w/blue specks	None Detected		100% Other	Brown Non Fibrous Homogeneous
51822875PLM_25	mastic				Dissolved

Disclaimer: Due to the nature of the EPA 600 method, asbestos may not be detected in samples containing low levels of asbestos. We strongly recommend that analysis of floor tiles, vermiculite, and/or heterogeneous soil samples be conducted by TEM for confirmation of "None Detected" by PLM. This report relates only to the samples tested and may not be reproduced, except in full, without the written approval of SAL. This report may not be used by the client to claim product endorsement by NVLAP or any other agency of the U.S. government. Analytical uncertainty available upon request. Scientific Analytical Institute participates in the NVLAP Proficiency Testing program. Unless otherwise noted blank sample correction was not performed. Estimated MDL is 0.1%.

William Howell (28)

Analyst

Approved Signatory



Bulk Asbestos Analysis

By Polarized Light Microscopy
 EPA Method: 600/R-93/116 and 40 CFR, Part 763, Subpart E,
 App.E



Customer: KEM
 6935 Wisconsin Ave Suite 306
 Chevy Chase, MD 20815

Attn: Carlos Elizondo

Lab Order ID: 51822875
Analysis ID: 51822875_PLM
Date Received: 9/7/2018
Date Reported: 9/11/2018

Project: 4701 Silver Hill Rd/23167

Sample ID	Description	Asbestos	Fibrous Components	Non-Fibrous Components	Attributes
Lab Sample ID	Lab Notes				Treatment
9-6-18-FT-14 - A	Floor tile tan 12x24 & mastic	None Detected		100% Other	Beige Non Fibrous Homogeneous
51822875PLM_14	tile				Dissolved
9-6-18-FT-14 - B	Floor tile tan 12x24 & mastic	None Detected		100% Other	Gray Non Fibrous Homogeneous
51822875PLM_26	mastic				Dissolved
9-6-18-FT-15 - A	Floor tile tan 12x24 & mastic	None Detected		100% Other	Beige Non Fibrous Homogeneous
51822875PLM_15	tile				Dissolved
9-6-18-FT-15 - B	Floor tile tan 12x24 & mastic	None Detected		100% Other	Gray Non Fibrous Homogeneous
51822875PLM_27	mastic				Dissolved
9-6-18-WBM-16	Wallboard mastic tan	None Detected		100% Other	Tan Non Fibrous Homogeneous
51822875PLM_16					Dissolved
9-6-18-WBM-17	Wallboard mastic tan	None Detected		100% Other	Tan Non Fibrous Homogeneous
51822875PLM_17					Dissolved
9-6-18-DW-18	Drywall	None Detected	10% Cellulose	90% Other	White Non Fibrous Homogeneous
51822875PLM_18					Crushed
9-6-18-DW-19	Drywall	None Detected	10% Cellulose	90% Other	White Non Fibrous Homogeneous
51822875PLM_19					Crushed

Disclaimer: Due to the nature of the EPA 600 method, asbestos may not be detected in samples containing low levels of asbestos. We strongly recommend that analysis of floor tiles, vermiculite, and/or heterogeneous soil samples be conducted by TEM for confirmation of "None Detected" by PLM. This report relates only to the samples tested and may not be reproduced, except in full, without the written approval of SAL. This report may not be used by the client to claim product endorsement by NVLAP or any other agency of the U.S. government. Analytical uncertainty available upon request. Scientific Analytical Institute participates in the NVLAP Proficiency Testing program. Unless otherwise noted blank sample correction was not performed. Estimated MDL is 0.1%.

William Howell (28)

Analyst

Approved Signatory



Bulk Asbestos Analysis

By Polarized Light Microscopy
EPA Method: 600/R-93/116 and 40 CFR, Part 763, Subpart E,
App.E



NVLAP Lab Code: 200664-0



Customer: KEM
6935 Wisconsin Ave Suite 306
Chevy Chase, MD 20815

Attn: Carlos Elizondo

Lab Order ID: 51822875
Analysis ID: 51822875_PLM
Date Received: 9/7/2018
Date Reported: 9/11/2018

Project: 4701 Silver Hill Rd/23167

Sample ID	Description	Asbestos	Fibrous Components	Non-Fibrous Components	Attributes
Lab Sample ID	Lab Notes				Treatment
9-6-18-FT-20 - A	Floor tile orange	None Detected		100% Other	Orange Non Fibrous Homogeneous
51822875PLM_20	tile				Dissolved
9-6-18-FT-20 - B	Floor tile orange	None Detected		100% Other	Cream, Transparent Non Fibrous Homogeneous
51822875PLM_28	mastic				Dissolved
9-6-18-FT-21 - A	Floor tile orange	None Detected		100% Other	Orange Non Fibrous Homogeneous
51822875PLM_21	tile				Dissolved
9-6-18-FT-21 - B	Floor tile orange	None Detected		100% Other	Cream, Transparent Non Fibrous Homogeneous
51822875PLM_29	mastic				Dissolved

Disclaimer: Due to the nature of the EPA 600 method, asbestos may not be detected in samples containing low levels of asbestos. We strongly recommend that analysis of floor tiles, vermiculite, and/or heterogeneous soil samples be conducted by TEM for confirmation of "None Detected" by PLM. This report relates only to the samples tested and may not be reproduced, except in full, without the written approval of SAL. This report may not be used by the client to claim product endorsement by NVLAP or any other agency of the U.S. government. Analytical uncertainty available upon request. Scientific Analytical Institute participates in the NVLAP Proficiency Testing program. Unless otherwise noted blank sample correction was not performed. Estimated MDL is 0.1%.

William Howell (28)

Analyst

Approved Signatory



Scientific Analytical Institute
 4604 Dundas Dr. Greensboro, NC 27407
 Phone: 336.292.3888 Fax: 336.292.3313
 www.sailab.com lab@sailab.com

Lab Use Only
 Lab Order ID: 51822875
 Client Code: _____

Company Contact Information	
Company: KEM	Contact: Carlos Elizondo
Address: 6935 Wisconsin Ave	Phone <input type="checkbox"/>
Suite 306	Fax <input type="checkbox"/>
Chevy Chase MD 20815	Email <input type="checkbox"/> : celizondo@kyn...

Billing/Invoice Information	Turn Around Times	
Company:	90 Min. <input type="checkbox"/>	48 Hours <input type="checkbox"/>
Contact: Same as Above	3 Hours <input type="checkbox"/>	72 Hours <input checked="" type="checkbox"/>
Address:	6 Hours <input type="checkbox"/>	96 Hours <input type="checkbox"/>
	12 Hours <input type="checkbox"/>	120 Hours <input type="checkbox"/>
	24 Hours <input type="checkbox"/>	144*Hours <input type="checkbox"/>

PO Number: CE
 Project Name/Number: 4701 Silver Hill Rd / 23167

Asbestos Test Types	
PLM EPA 600/R-93/116 (PLM)	<input checked="" type="checkbox"/>
Positive stop	<input checked="" type="checkbox"/>
PLM Point Count 400 (PT4)	<input type="checkbox"/>
PLM Point Count 1000 (PTM)	<input type="checkbox"/>
PCM NIOSH 7400-A Rules (PCM)	<input type="checkbox"/>
B Rules (PCB) <input type="checkbox"/> TWA (PTA) <input type="checkbox"/>	
TEM AHERA (AHE)	<input type="checkbox"/>
TEM Level II (LII)	<input type="checkbox"/>
TEM NIOSH 7402 (TNI)	<input type="checkbox"/>
TEM Bulk Qualitative (TBL)	<input type="checkbox"/>
TEM Bulk Chatfield (TBS)	<input type="checkbox"/>
TEM Bulk Quantitative (TBQ)	<input type="checkbox"/>
TEM Wipe ASTM D6480-05	<input type="checkbox"/>
TEM Microvac ASTM D5755-02	<input type="checkbox"/>
TEM Water EPA 100.2 (TW1)	<input type="checkbox"/>
Other: _____	<input type="checkbox"/>

Sample ID #	Description	Volume/Area	Comments	
9-6-18-WM-1	Black Wall Mastic (Black) (1)		Accepted <input checked="" type="checkbox"/> Rejected <input type="checkbox"/>	
9-6-18-WM-2	Wall Mastic (Black) (2)			
9-6-18-JC-4	Drywall Joint Compound 1st Floor (3)			
9-6-18-JC-5	Drywall Joint Compound Basement Stairs (4)			
9-6-18-CT-6	Ceiling Tile 1st Floor (5)			
9-6-18-CT-7	Ceiling Tile 1st Floor (6)			
9-6-18-CBM-8	Cove Base Mastic Tan (7)			
9-6-18-CBM-9	Cove Base Mastic Tan (8)			
9-6-18-FT-10	Floor Tile Blue 12x12+Mastic (9)			12x12 + Mastic
9-6-18-FT-11	Floor Tile Blue 12x12+Mastic (10)			12x12 + Mastic
9-6-18-FT-12	Floor Tile White w/blue specks (11)			12x12 ⁽¹⁰⁾ + Mastic
			Total # of Samples 28	

Relinquished by	Date/Time	Received by	Date/Time
<i>[Signature]</i>	4:39 pm 9/6/18	N. Kanaujia	9/7 10:30a

Appendix C

Floor Plan with Sample Locations

SWAN ROAD

SYCAMORE LANE

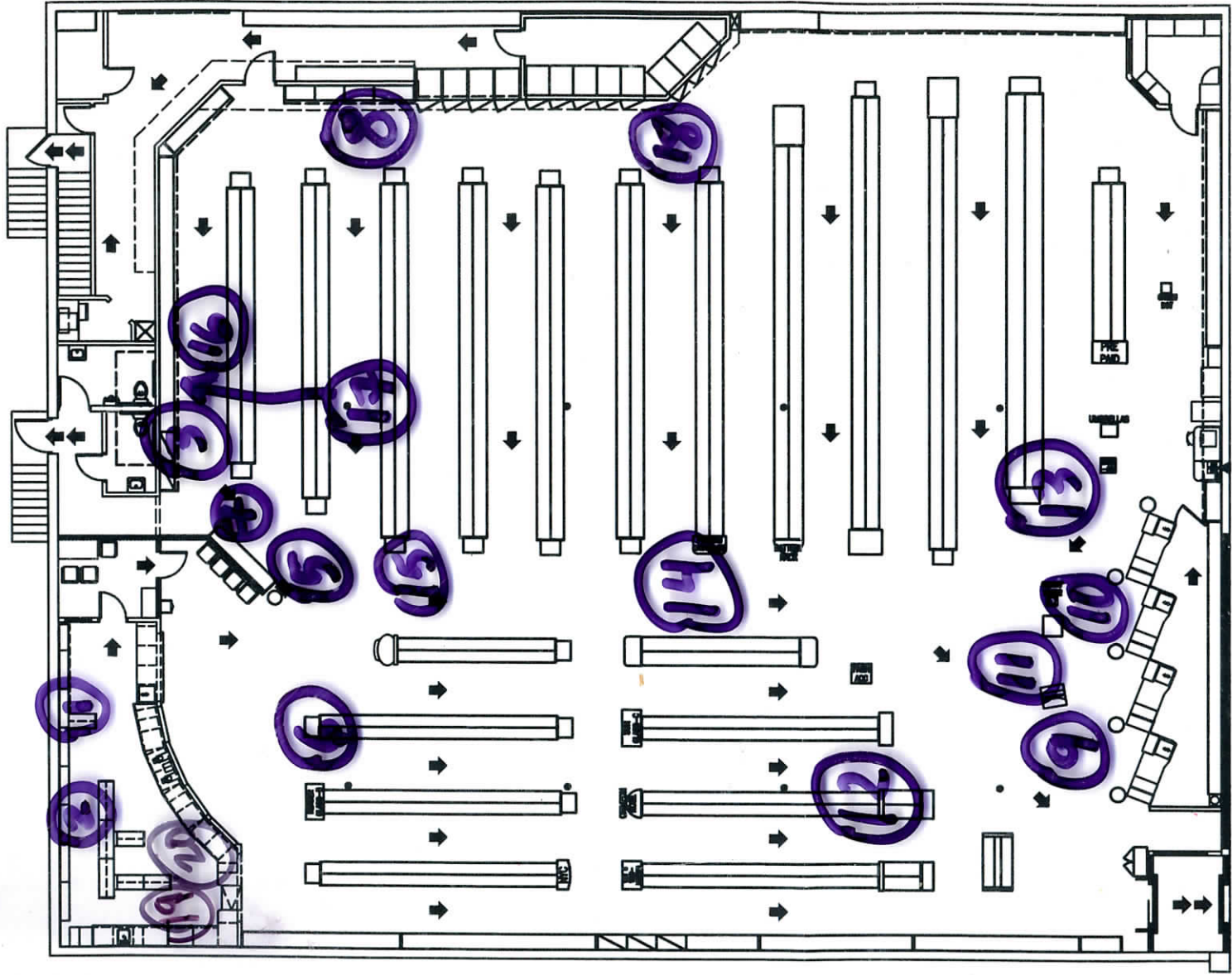

SILVER HILL ROAD

SUITLAND ROAD