



Redevelopment Authority
of Prince George's County

Stephen J. Paul
Executive Director



Angela D. Alsobrooks
County Executive

9200 Basil Court, Suite 504 | Largo, Maryland 20774 | Office: 301.883.5300 | Fax: 301.883.5291

RFP NO. 2021 - 03

Redevelopment of the Former Hospital Site located at 3001 and 3005 Hospital Drive Hyattsville, MD 20785

Deed Plot
08/16/2021

To All Prospective Respondents:

Please note the following changes, additions, and information presented herein in connection with the above referenced project. The Prospective Respondents shall be governed accordingly. This addendum is hereby made part of the contract documents of which explains and/or corrects the original document. The following attachment shows the revised parcel boundary. The deed plot replaces the site boundary shown in the RFP document.



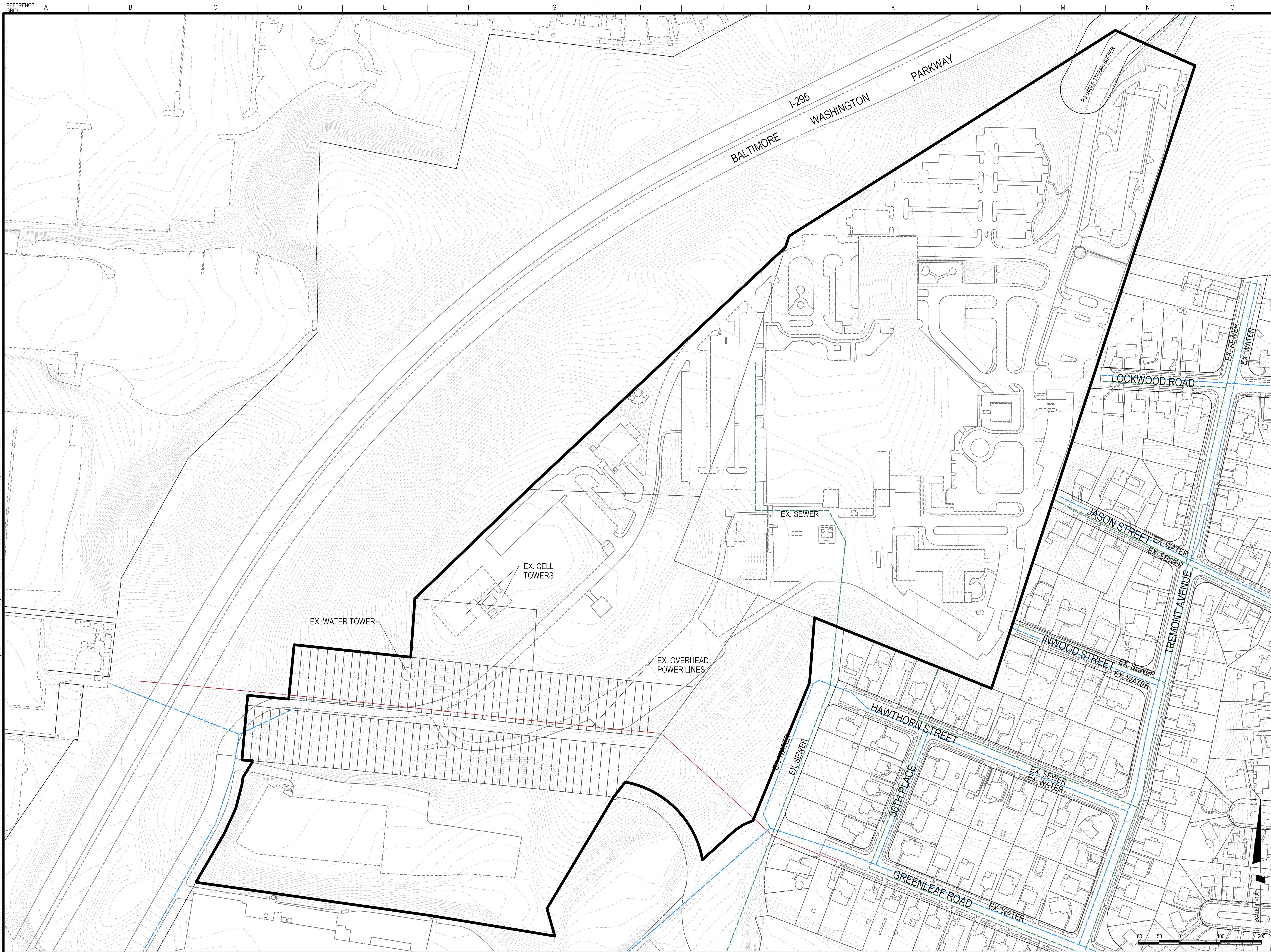

The original of this drawing document was prepared by Soltesz, Inc. (SOLTESZ). If this document was not obtained directly from SOLTESZ and/or it was transmitted electronically, SOLTESZ cannot guarantee the unauthorized changes and/or alterations were not made by others. A verification of the information contained herein is needed. Contact should be made directly with SOLTESZ. SOLTESZ makes no warranty, express or implied, concerning the accuracy of any information that has been transmitted by electronic means.

SOLTESZ, LLC
 4300 Forbes Boulevard, Suite 230
 Lanham, MD 20706
 P. 301.794.7555 F. 301.794.7656
 www.solteszco.com

Engineering
 Surveying
 Planning
 Environmental Sciences

NO.	REVISIONS	BY	DATE

MISS UTILITY NOTE
 INFORMATION CONCERNING EXISTING UNDERGROUND UTILITIES WAS OBTAINED FROM AVAILABLE RECORDS. THE CONTRACTOR MUST DETERMINE THE EXACT LOCATION AND ELEVATION OF ALL EXISTING UTILITIES AND UTILITY CROSSINGS BY DIGGING TEST PITS BY HAND, WELL IN ADVANCE OF THE START OF EXCAVATION. CONTACT "MISS UTILITY" AT 1-800-251-7777, 48 HOURS PRIOR TO THE START OF EXCAVATION. IF CLEARANCES ARE LESS THAN SHOWN ON THIS PLAN OR TWELVE (12) INCHES, WHICHEVER IS LESS, CONTACT THE ENGINEER AND THE UTILITY COMPANY BEFORE PROCEEDING WITH CONSTRUCTION. CLEARANCES LESS THAN NOTED MAY REQUIRE REVISIONS TO THIS PLAN.

OWNER / DEVELOPER / APPLICANT

EXISTING CONDITIONS PLAN
UNIVERSITY OF MD
PRINCE GEORGE'S
HOSPITAL CENTER
3001 HOSPITAL DRIVE
 BLADENBURG(MD) ELECTION DISTRICT PRINCE GEORGE'S COUNTY, MARYLAND

TAX MAP: 50-F4 & 58-F1 ZONING CATEGORY: R-55

WSSC 200' SHEET: 204NE05 SECTOR PLAN: APPROVED GREATER CHEVERLY SECTOR PLAN

SITE DATUM: DATE: 11/24/2020

HORIZONTAL: TECHNICAL: DJB

VERTICAL: CHECKED: DJB

SCALE: 1" = 100' SHEET: 1 OF 1

CAD STD'S: V8 / NCS PROJECT NO.:

