

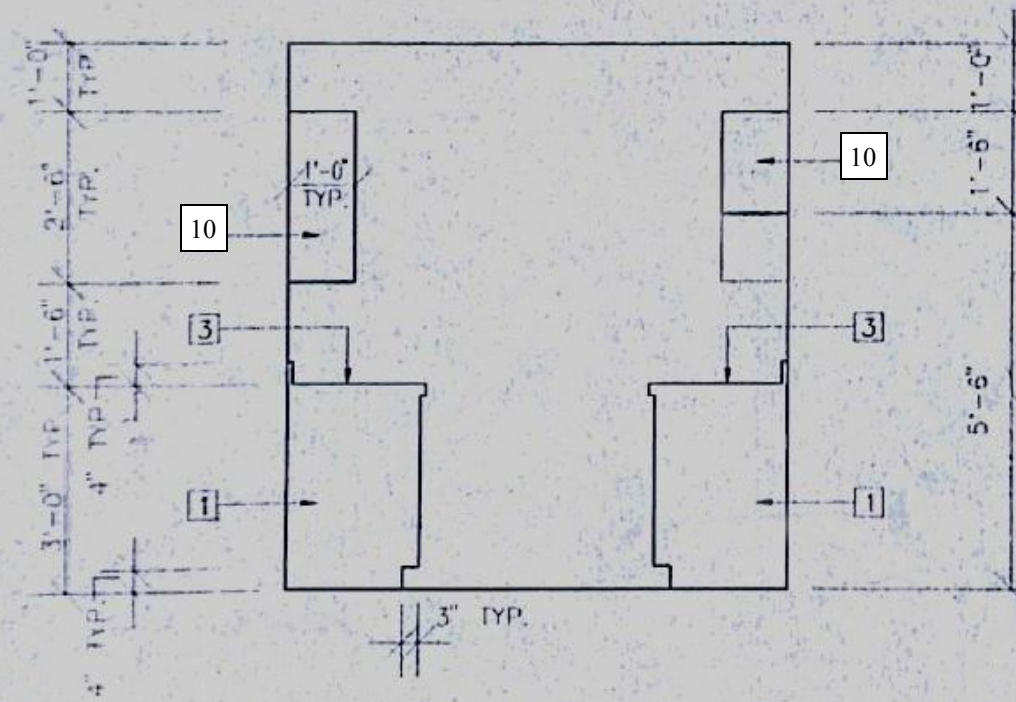

1 TYPICAL KITCHEN (1 BEDROOM)
A1/A16 SCALE: 1/2" = 1'-0" (BLDGS. A,B,C,D)

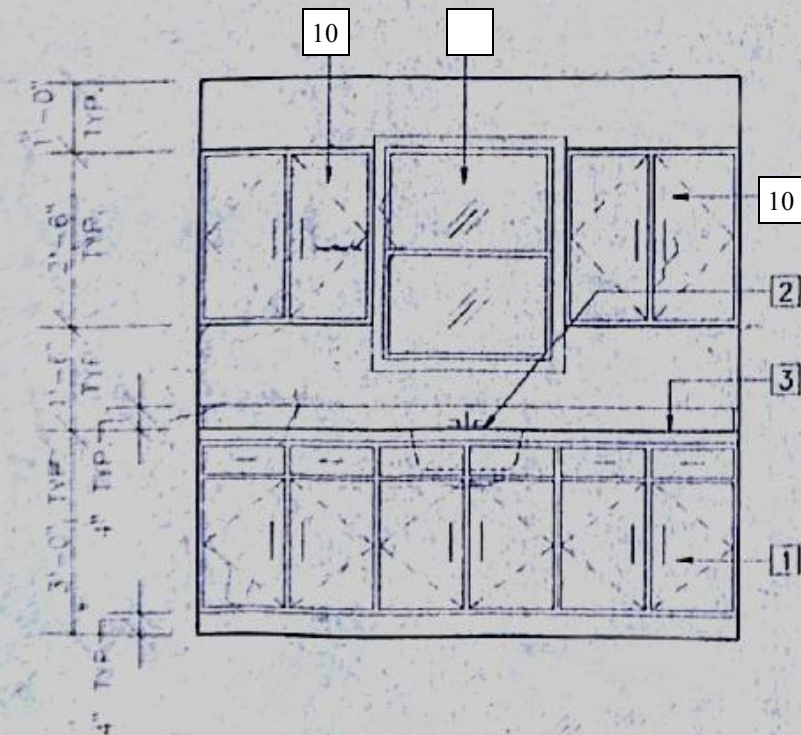

2 TYPICAL KITCHEN (1 BEDROOM)
A1/A16 SCALE: 1/2" = 1'-0" (BLDGS. A,B,C,D)



3 TYPICAL KITCHEN (1 BEDROOM)
A1/A16 SCALE: 1/2" = 1'-0" (BLDGS. A,B,C,D)

Notes:

1. Remove existing wood base cabinets and install new base cabinets
2. Remove existing sink and install new single bowl stainless steel sink
3. With pull-out water sense faucet
4. Remove existing counter top and install new plastic laminate counter, backsplash and return (typical)
5. Remove existing range hood and install new range hood
6. Remove existing range and install new range
7. Remove existing drawers and install new wood drawers
8. Install new light switch
9. Install new refrigerator
10. Install new wall cabinets
11. Install new range hood
12. Re-Insulate all exposed pipes

Housing Authority of Prince George's County -
Marlborough Towne Renovation

1 bedroom Unit (Typical)
Kitchen Elevations