



Prince George's County

7th GREEN SUMMIT

annual

DEPARTMENT OF THE ENVIRONMENT

2021

WASTE DIVERSION



HOW TO RECYCLE RIGHT AND AVOID CONTAMINATION

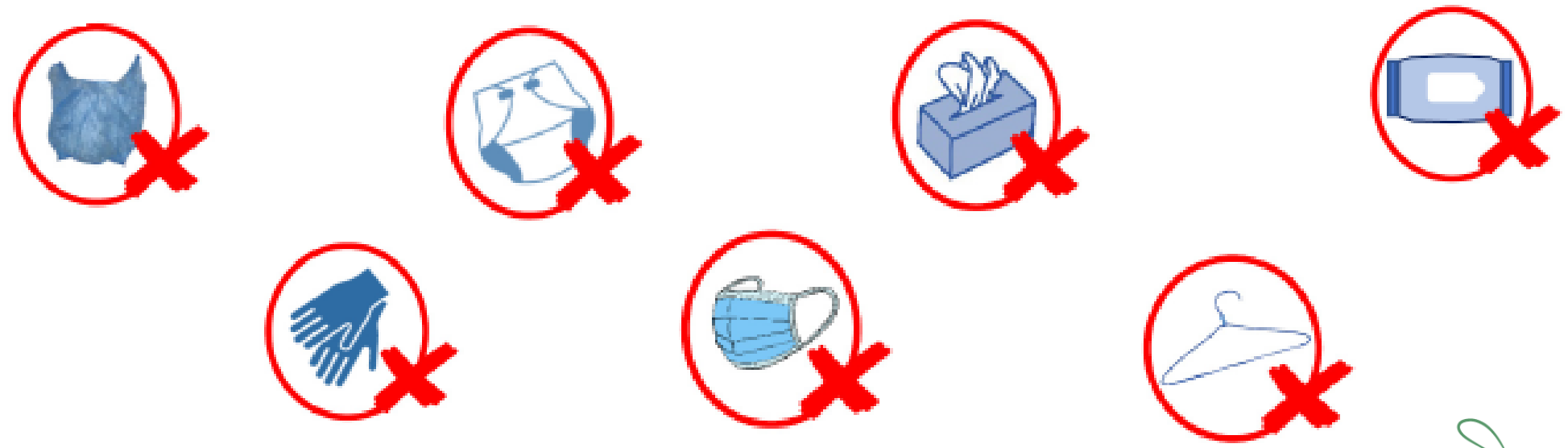



RECYCLING CONTAMINATION

- Contamination is COSTLY – in down time and money.
- Processing stops, laborers are idle; equipment repairs are expensive.
- Causes a back log of recyclables on the tipping floor.
- Reduces productivity and revenue.
- Contaminants in the bales diminishes the value of recyclable materials and causes materials to be rejected by end markets.



****Remember, when in doubt leave it out!****

To view a list of acceptable and non- acceptable recyclables, visit
bit.ly/wastetoolkit

TOP 5 RECYCLING MISTAKES



- PLASTIC BAGS
- CHIP or SNACK BAGS
- CANDY WRAPPERS



- GARDEN HOSES
- ROPES
- CORDS



- BATTERIES
- ELECTRONICS
- HOUSEHOLD HAZARDOUS MATERIALS
- BALLOON HELIUM TANKS
- SMALL PROPANE TANKS



- CLOTHING
- WIRE & PLASTIC CLOTHES HANGERS



- DIAPERS
- TISSUES
- HYGIENE PRODUCTS
- PERSONAL PROTECTIVE EQUIPMENT (PPE)



RECYCLE RIGHT / RECICLA CORRECTO



ACCEPTABLE ITEMS



ALUMINUM • ALUMINUM FOIL
BIMETAL • STEEL FOOD & BEVERAGE
CONTAINERS

GABLE TOP BEVERAGE CONTAINERS

FLATTENED CORRUGATED CARDBOARD BOXES • FROZEN
FOOD PACKAGING • PAPER BOARD CONTAINERS

All containers
must be clean
and empty



ARTÍCULOS ACEPTABLES



ALUMINIO • PAPEL DE ALUMINIO
BIMETAL • CONTENEDORES DE •
ALIMENTOS Y BEBIDAS DE ACERO •
LATAS DE AEROSOL VACÍAS

CONTENEDORES DE BEBIDAS GABLE-TOP

CAJAS DE CARTÓN CORRUGADO APLANADO • ENVASADO DE
ALIMENTOS CONGELADOS • CONTENEDORES DE CARTÓN

Todos los
contenedores deben
ser limpiados y
vacíados.



Click to view full flyers or visit bit.ly/wastetoolkit.
For accepted items, visit bit.ly/acceptedpgc.



FOAM: IS IT TRASH OR RECYCLING?



youtu.be/VGw_dcyip4o



PRINCE GEORGE'S IS FOAM FREE!



Starting July 1, 2016, polystyrene (commonly referred to as Styrofoam™), polystyrene loose fill packaging (also known as “packing peanuts”) and other foam articles are not permitted for sale or use in Prince George’s County.

EXAMPLES OF SINGLE-USE FOAM PACKAGING THAT CANNOT BE SOLD OR USED *visit environment.mypgc.us/foamfree for exemption information

Food Containers



Plates



Hot and Cold Beverage Cups



IT'S THE LAW



WHY THE BAN?

To reduce the amount of polystyrene waste entering the landfill and littering our roadways, neighborhoods and local waterways, the County is requiring the use of non-foam food packaging products that are environmentally-friendly.



WHICH BUSINESSES ARE AFFECTED?

- Full and limited-service restaurants
- Fast food restaurants
- Cafés and delicatessens
- Cafeterias
- Coffee shops
- Convenience stores
- Discount stores
- Dollar Stores
- Supermarkets and grocery stores
- Food carts or trucks
- Pack and ship stores
- Retailers and wholesalers selling disposable dishware, storage containers, packing materials and polystyrene products



WHAT CAN BE USED OR SOLD?

There are many non-foam food packaging alternatives. Some examples include recyclable and compostable containers that are rigid plastic or paper-based. Visit environment.mypgc.us to view a list of vendors that offer comparable products or contact CountyClick at 3-1-1.

Please visit environment.mypgc.us/foamfree for more information

#foamfreeinpgc





PLASTIC BAGS NOT ACCEPTED

Plastic bags are **not accepted** in the curbside collection of recyclable or organics (food scraps and yard trim).

Here's what **NOT** to recycle ►

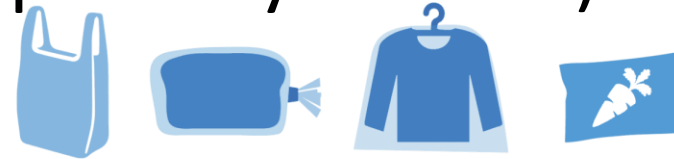

Any grocery, retail or trash plastic bag

Bread bags

Dry cleaning bags

Fruit and vegetable bags (fresh/frozen)

Garden product bags (soil/mulch)

Newspaper bags

Outer wrap from paper towel, napkin and diaper packages

Outer wrap from cases of soda, juice and snacks

Zipper or stand-up pouches, bubble or cling wrap

Crinkle bags for cereal, pasta or snack bags

Outer wrap from meat or cheese products

Drop them off at the nearest participating location by visiting:

www.plasticfilmrecycling.org.



ELECTRONICS AND HOUSEHOLD ITEMS

Electronic waste contains many valuable, recoverable materials such as aluminum, copper, gold, silver, plastics, and ferrous metals. In order to conserve natural resources and energy, old or broken electronic equipment can be refurbished, reused or recycled instead of being thrown away and landfilled.

- Many items can be brought to the Electronics Recycling Acceptance Site, located at the landfill. For more information, visit bit.ly/pgcelectronicwaste.
- Check with local retailers to see some of the electronics they accept, such as Best Buy, Staples, Ikea, Home Depot, MOMs Organic Market and others!

Materials from large and bulky household items, like appliances, furniture, mattresses, or carpets, **should never be left on your property**. Bring these items to the landfill or schedule a bulky curbside collection appointment.



youtu.be/9CKBsT0WWQo

Stash Your Trash!

This chart will help you find the appropriate place to properly dispose of litter and debris to bring your property into compliance.



VIOLATION	SOLUTION
Dumping tires	Call 311 to schedule a bulky trash pickup. They will take up to four tires per trip. You can always schedule additional pickups to dispose of more tires.
Storing construction materials	Dispose of construction materials at the Richland Reclamation Landfill, 2001 Ritchie Road, Upper Marlboro. Vehicles are charged by size. Call 301-350-4059 for details. Mon-Fri, 7:00 AM-4:00 PM
Storing old furniture, broken appliances and fixtures, junk and debris	Call 311 to schedule a bulky trash pickup. Mon-Fri, 7:00 AM-7:00 PM
Keeping large loads of trash that does not qualify for weekly pickup	Transport items to the Brown Station Road Sanitary Landfill, 11611 White House Road, Upper Marlboro. Call 301-952-7625 for details. Mon-Sat, 8:00 AM-3:30 PM
Harboring hazardous materials and old electronics on your property	Take the materials to the Household Hazardous Waste Acceptance Site and Electronics Recycling Acceptance Site, 11611 White House Road, Upper Marlboro. Thur-Sat, 8:00 AM-3:30 PM



SCHEDULE YOUR BULKY TRASH COLLECTION

CURBSIDE BULKY TRASH COLLECTION



Residents can
now schedule
appointments
for **NOVEMBER**.

TO SCHEDULE AN APPOINTMENT

📞 CALL: 311 OR

🌐 VISIT: [BULKYTRASH.PRINCEGEORGESCOUNTYMD.GOV](https://bulkytrash.princegeorgescountymd.gov).



NOVEMBER curbside bulky trash appointments are now being scheduled.

Items that are too big to fit in your trash bin won't be hauled away in your regular curbside trash collection.

Schedule your curbside bulky trash appointment today by calling 311 or visiting bulkytrash.princegeorgescountymd.gov.

Accepted items and more information can be found at bit.ly/PGCbulkyacceptable.





Programe su Cita para Recolección de Residuos Voluminosos

Los artículos que son muy grandes para caber en su contenedor de basura no serán transportados en la recolección regular de residuos en la acera.

Programe su cita para recolección de residuos voluminosos hoy llamando al 311 o visitando

bulkytrash.princegeorgescountymd.gov.

Los artículos aceptados y más información se pueden encontrar en

bit.ly/PGCbulkyacceptable.

RECOLECCIÓN DE BASURA VOLUMINOSA EN LA ACERA



Los residentes
pueden programar
citas para
NOVIEMBRE.

PARA PROGRAMAR UNA CITA

LLAME AL: 311 O

VISITE: BULKYTRASH.PRINCEGEORGESCOUNTYMD.GOV.





LIST OF ACCEPTABLE AND NON-ACCEPTABLE ITEMS FOR BULKY TRASH COLLECTION

Acceptable Materials

- Carpet and padding (*Limit of carpet and padding is 324 sq. ft. - rolled and tied on ends*)
- Doors and cabinets (*limit of 3 each*)
- Furniture and refrigerators (*Limit of 5 appliances per pickup; doors must be taped shut*)
- Hot water heaters and lawn mowers (*Remove the gas tank and drain the oil from lawn mowers*)
- Other large materials/furniture items generated in the household that are not picked up by refuse collection
- Smaller household items:
 - Must be placed in bags or boxes
 - Limit any combination of bags and boxes to 10
 - Weight limit of 60 pounds per bag or box
 - Vehicle Tires (Limit of 4; vehicle tires only, no truck tires)
- Washing machines and dryers

Effective February 1, 2019, for the health and safety of staff, Prince George's County residents requesting curbside collection of Bulky items will be required to completely cover mattresses and box springs in a protective plastic covering. Mattresses and box springs delivered to the landfill by residents will not be required to be covered in protective encasement.

Non-Acceptable Materials

- Animal carcasses
- Asbestos
- Ash
- Automobiles or auto parts
- Chemical and/or petroleum cleanup waste
- Compressed cylinders of any size, shape or condition
- Construction and demolition (C&D) debris
- Drums, tanks, kegs and barrels (plastic and metal) greater than 55 gallons in size (unless the sides are removed and the vessel flattened prior to collection)
- Fencing/sheds/gazebos
- Glass
- Hazardous and bio-hazardous medical waste
- Home renovation/remodeling debris
- Household trash
- Liquids, including paint, sewage and septic waste
- Materials from evictions, foreclosures, unoccupied properties, commercial properties or apartment complexes
- Mirrors
- Plastic packing materials and plastic sheeting
- Radioactive material
- Riding lawnmowers
- Shingles, roofing materials
- Skids and pallets
- Soil, rocks, grubbing material and spoil
- Stumps and logs
- Windows
- Wood (unless it is a piece of furniture)



HOUSEHOLD HAZARDOUS WASTE & ELECTRONICS RECYCLING

HOURS OF OPERATION

- Thursday, Friday, & Saturday
- 8 a.m. – 3:30 p.m.

LOCATION

Brown Station Road Sanitary Landfill

11611 White House Road

Upper Marlboro MD 20774

Use the White House Road entrance.

- Materials must be dropped off at facility
- Residential materials only.

****Incorrect disposal of batteries or propane tanks can cause fires or explosions!****



ACCEPTABLE ITEMS:

Acid Car Batteries

Automotive Fluids and Fuels

Cleaning Agents

Cooking Oil

Driveway Sealers

Fire Extinguishers

Fluorescent Light Bulbs

Gas Grill Propane Tanks

Helium Balloon Tanks

Household Batteries

Insecticides, Herbicides, and Fertilizers

Mercury and Other Hazardous Materials

Oil-Based Paints

Photographic Chemicals

Poisons

Smoke Detectors

Solvents, Varnishes, and Stains

Swimming Pool Chemicals

For more information, visit bit.ly/hwaste



PROPER BATTERY DISPOSAL



youtu.be/JKkz01ofTX8



FOR MORE INFORMATION, VISIT THE FOLLOWING RESOURCES:

bit.ly/wastetoolkit

bit.ly/acceptedpgc

bit.ly/PGCbulkyacceptable

bit.ly/hwaste